



1, BARLEY CLOSE WOODSEAVES ROAD  
EARDISLEY, HEREFORD HR3 6PQ

£750,000  
FREEHOLD

This attractive, newly constructed detached property combines traditional style with modern efficiency and offers scope for completion allowing a buyer to finish a home to their own taste. Extending to approximately 1,961 sq ft, it provides excellent living space with four double bedrooms (two ensuite), air source heating, and high-quality fittings throughout. The home also benefits from a double garage, driveway parking & generous gardens. Viewing highly recommended.





**Ground Floor**  
Approx. 126.5 sq. metres (1362.0 sq. feet)

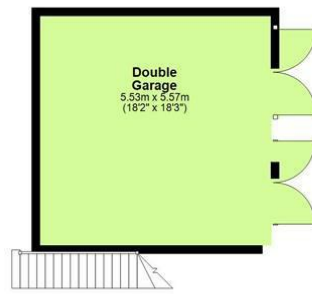

**First Floor**  
Approx. 106.2 sq. metres (1143.2 sq. feet)

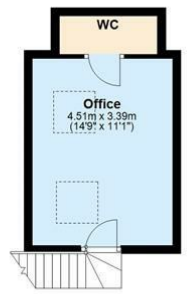

Total area: approx. 232.7 sq. metres (2505.2 sq. feet)



**EPC Rating:**      **Council Tax Band: New Build**

Agents Note: Whilst every care has been taken to prepare these particulars, they are for guidance purposes only. All measurements are approximate and are for general guidance purposes only and whilst every care has been taken to ensure their accuracy, they should not be relied upon and potential buyers/tenants are advised to recheck the measurements

**Flint and Cook Hereford Sales** 01432 355455  
22 Broad Street  
Hereford  
Herefordshire  
HR4 9AP

hereford@flintandcook.co.uk  
flintandcook.co.uk

